

2022

MOBILE TICKET TUTORIAL

DOWNLOAD THE GILLETTE STADIUM APP



LOGGING IN TO YOUR ACCOUNT

TUTORIAL

LOGGING IN TO YOUR ACCOUNT

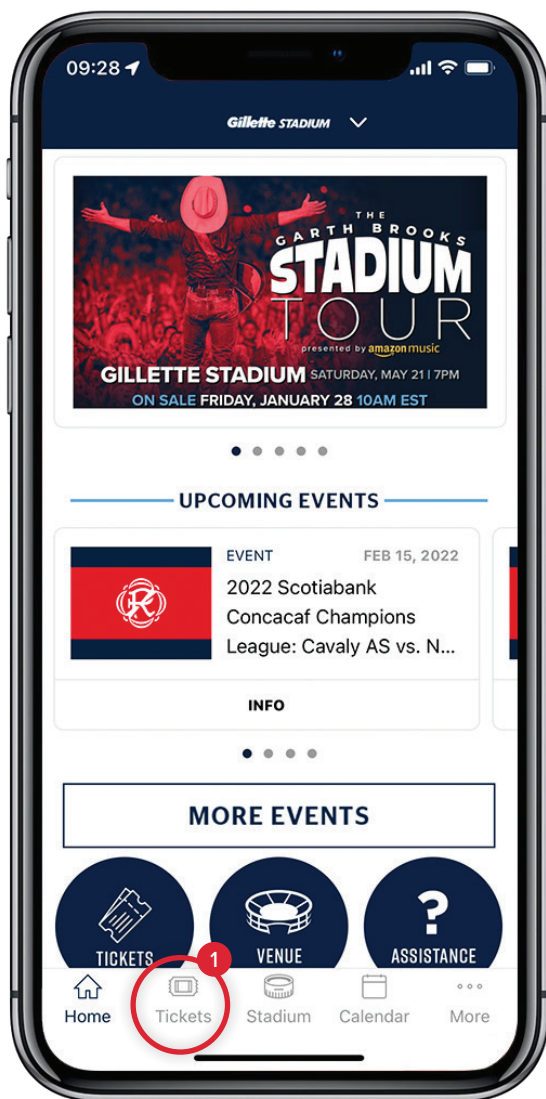

- 1 To access mobile tickets, select TICKETS from the Gillette Stadium App home screen

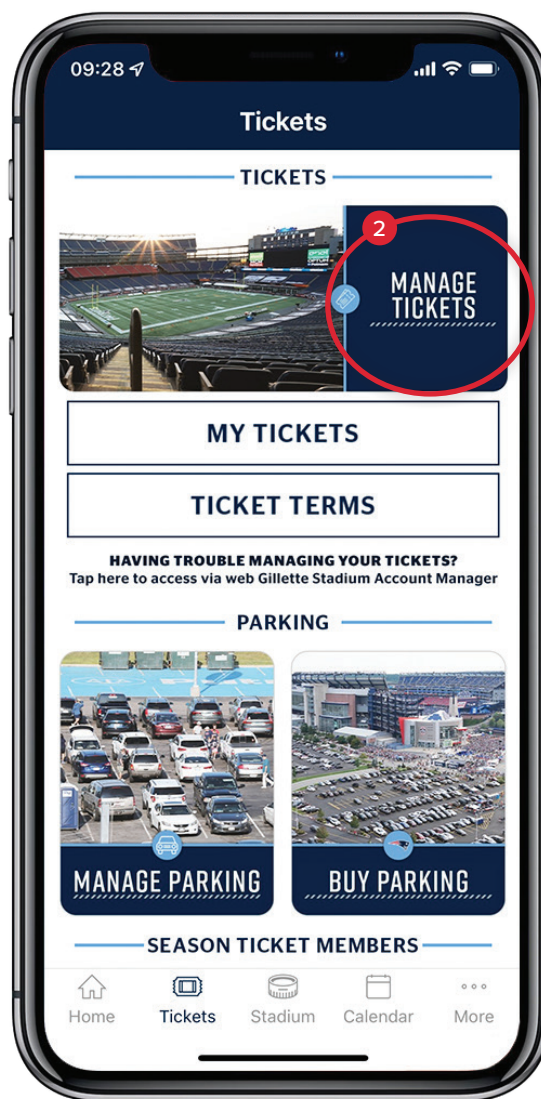

- 2 Then, select MANAGE TICKETS

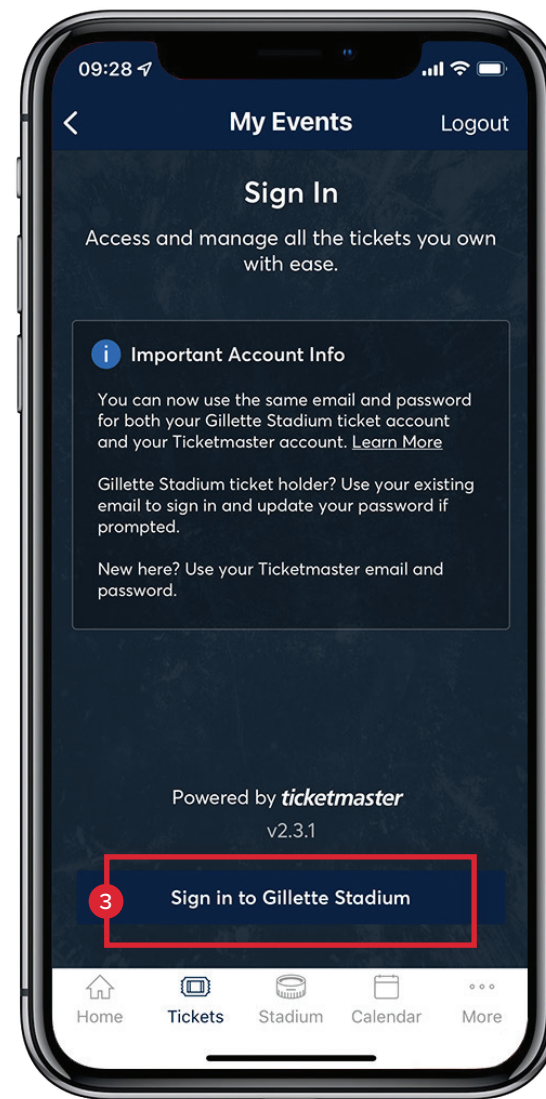

- 3 Select SIGN IN TO GILLETTE STADIUM

LOGGING IN TO YOUR ACCOUNT

IMPORTANT: Initially, you may need to change your password. Doing so will keep your information safer than ever before while making it even easier for you to log in moving forward.

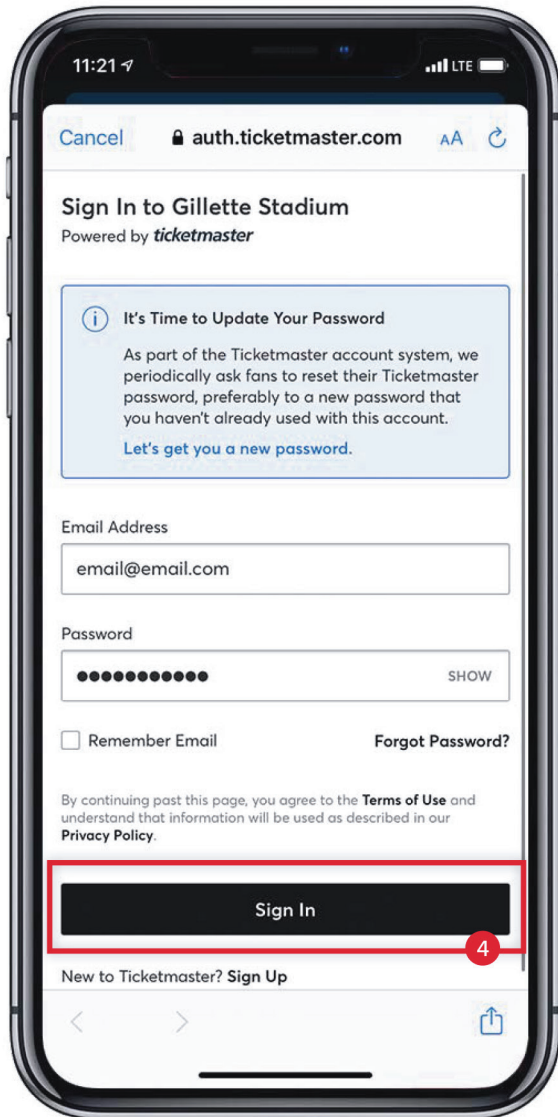

④ Enter your account credentials and tap SIGN IN

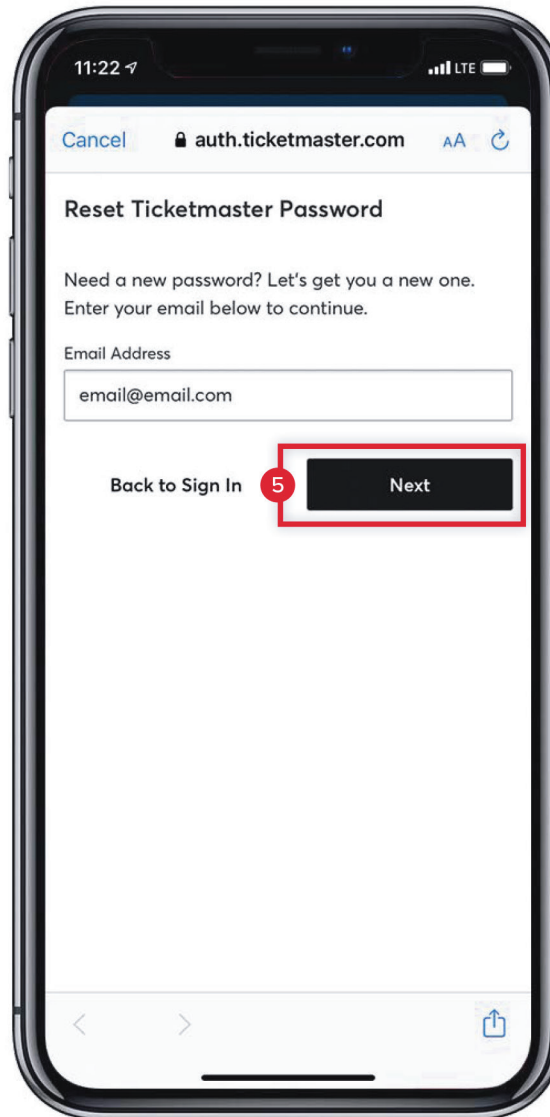

⑤ You may be prompted to reset your password. This is done to ensure your account is secure. Enter the email address associated with your account and tap NEXT.

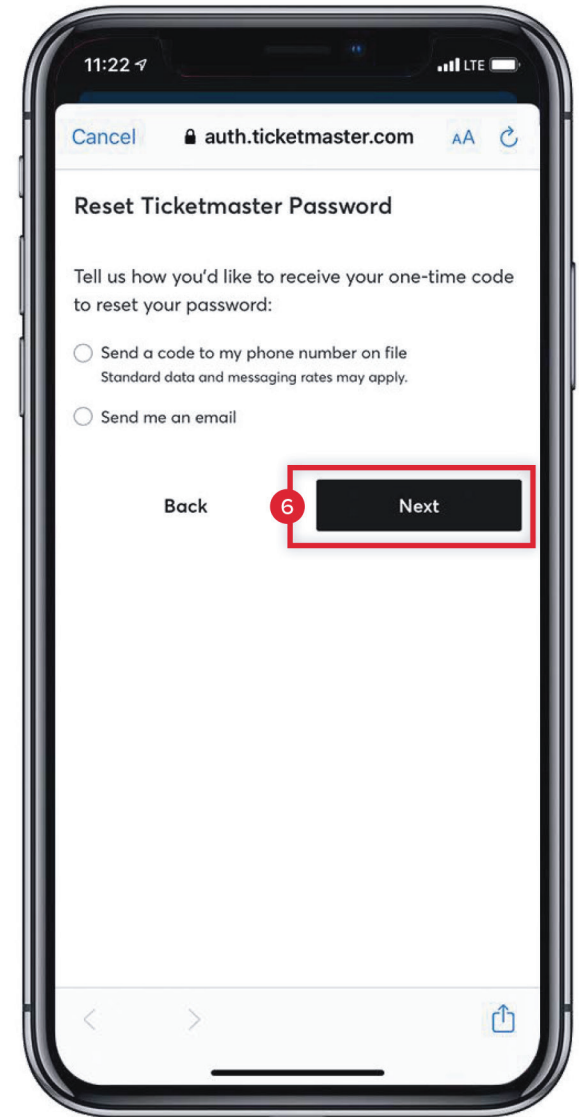

⑥ Tap NEXT after selecting one of the options listed above.

LOGGING IN TO YOUR ACCOUNT

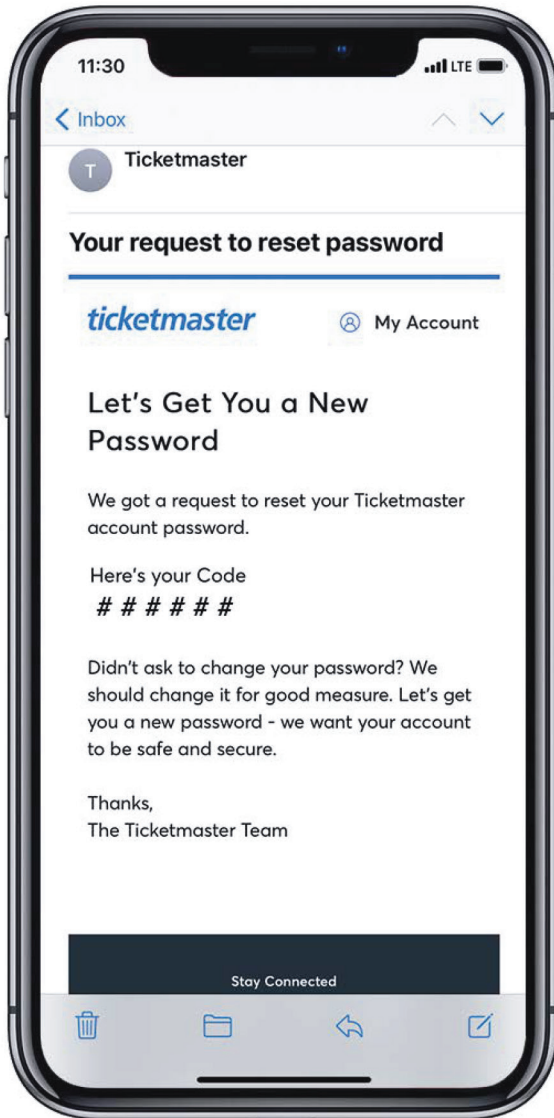

- 7 If you requested to have a code sent to you via email, you will receive an email from **customer_support@email.ticketmaster.com** within a few minutes.

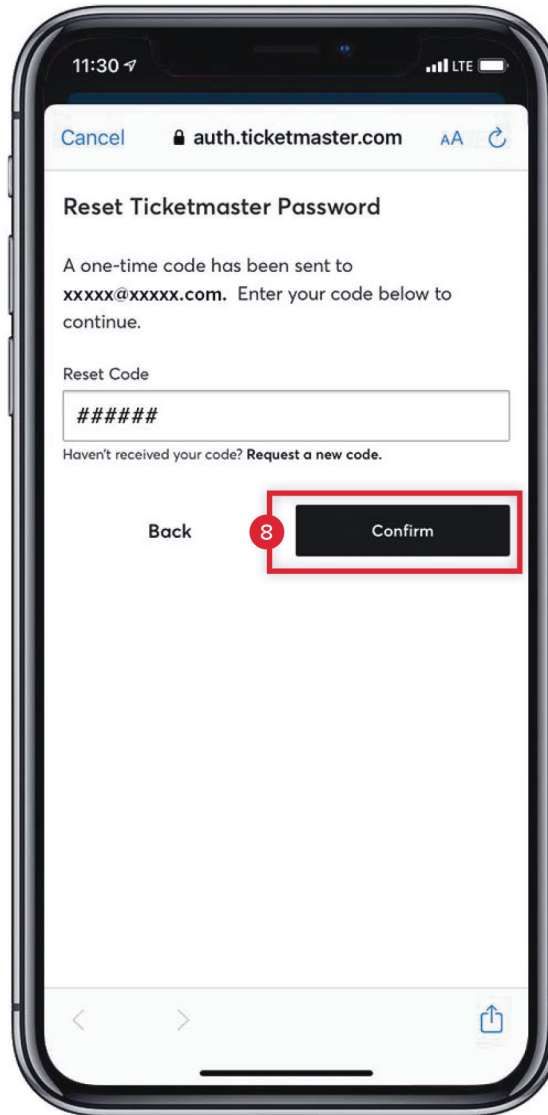

- 8 Enter the one-time code and tap CONFIRM.

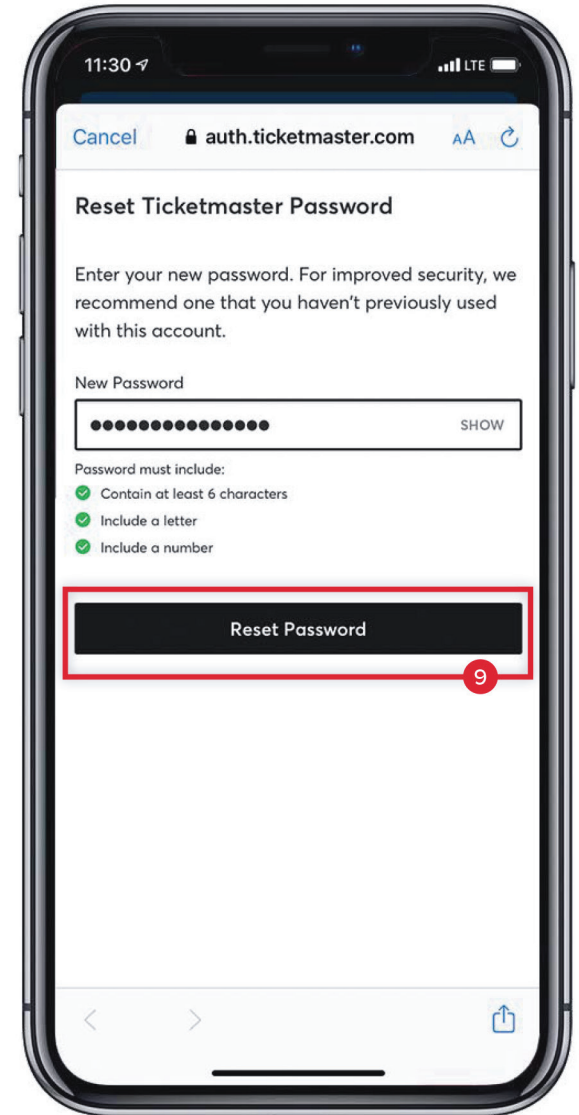

- 9 Enter a new password which meets all of the requirements listed above. **NOTE:** You may not change the password to one you have used before. Please store your password somewhere secure.

LOGGING IN TO YOUR ACCOUNT

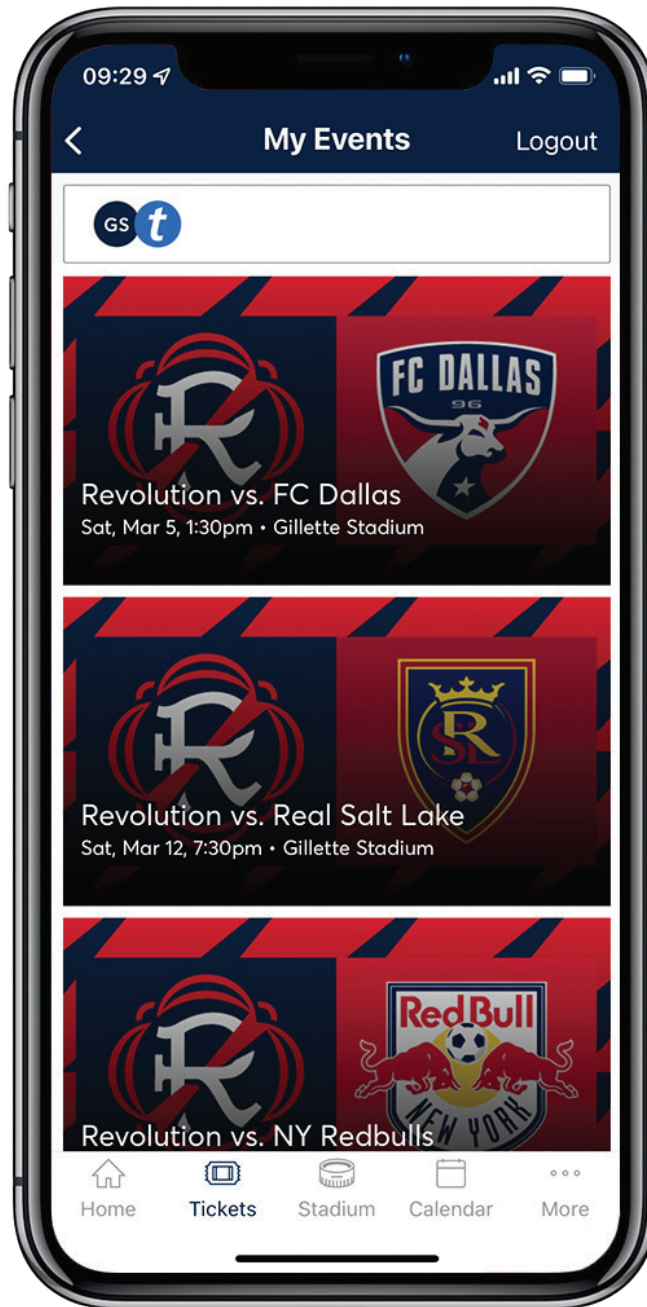

10

Once logged into your account, you will see a listing of all your upcoming tickets. Tap on the icon for the game/event you are attending

VIEWING AND USING YOUR TICKETS

TUTORIAL

VIEWING AND USING YOUR TICKETS

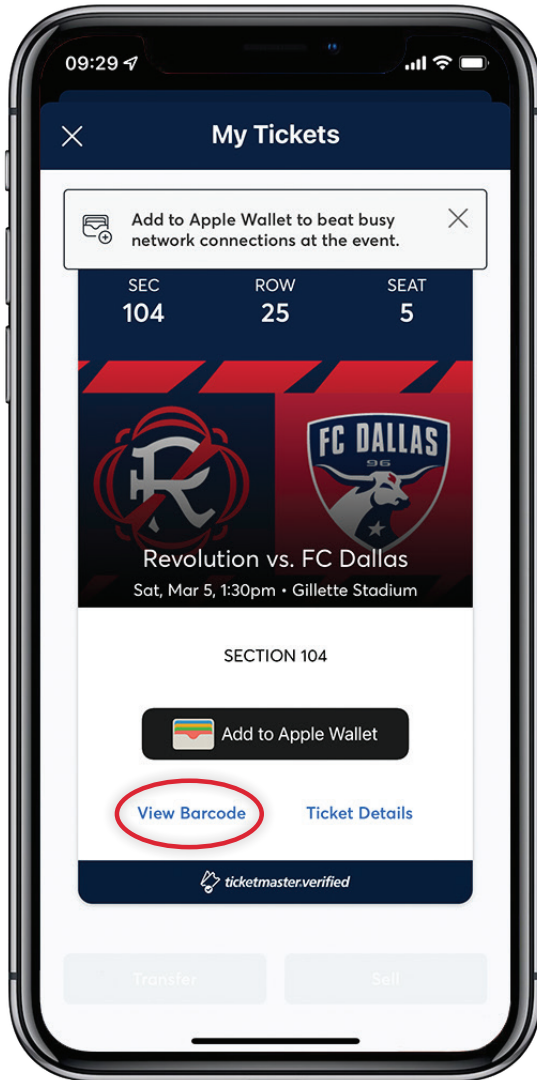

Tap VIEW BARCODE to display the SafeTix™ barcode(s) for the game/event.

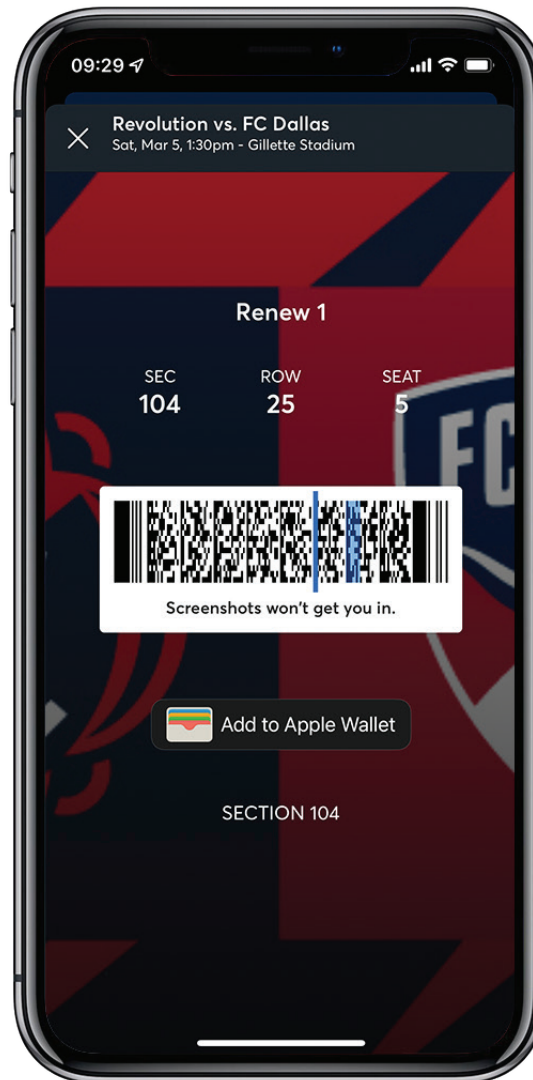

iPhone users can add tickets to Apple Wallet. To enter, open your Apple Wallet and hover your smartphone over the scanner to validate. Android users will be able to add their tickets to Google Pay.

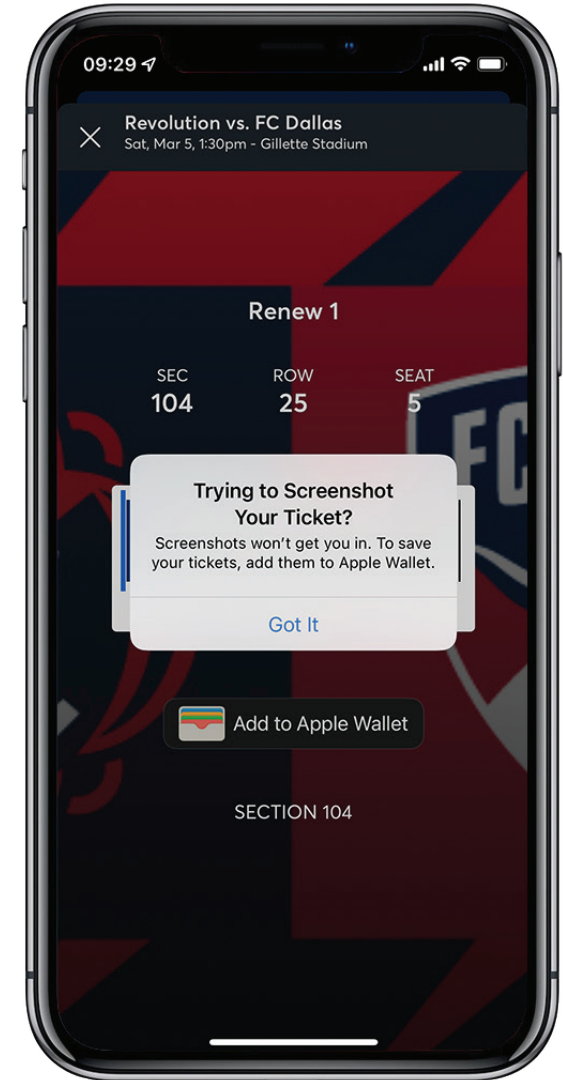

IMPORTANT: Screenshots of barcodes will not be accepted at stadium gates. You must log in to your account to scan your tickets.

TRANSFER TICKETS

TUTORIAL

TRANSFER TICKETS

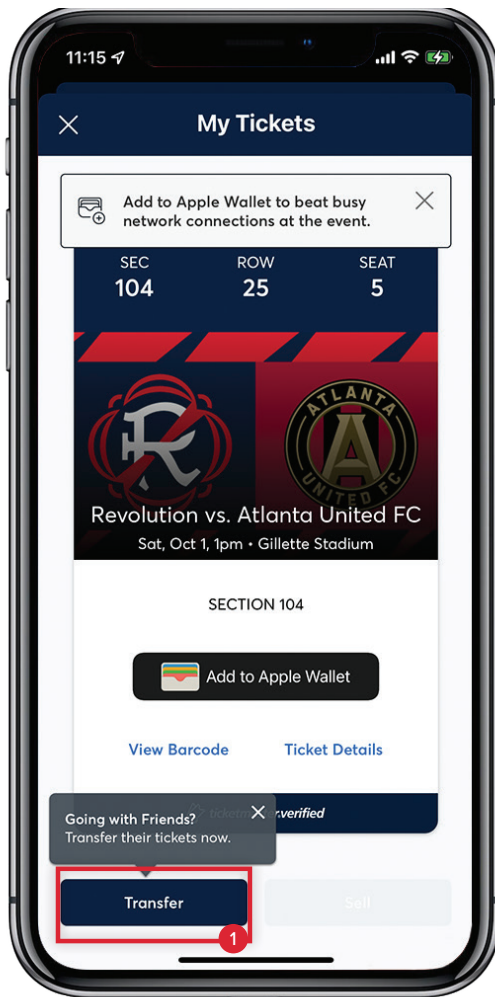

1

To transfer a ticket(s) to a game or event, tap TRANSFER .

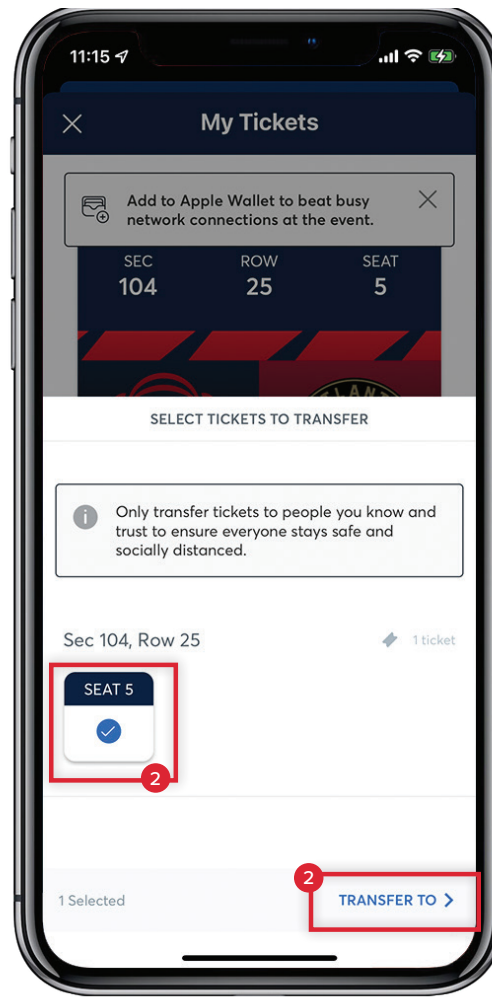

2

Select the ticket(s) you would like to transfer, then tap TRANSFER TO.

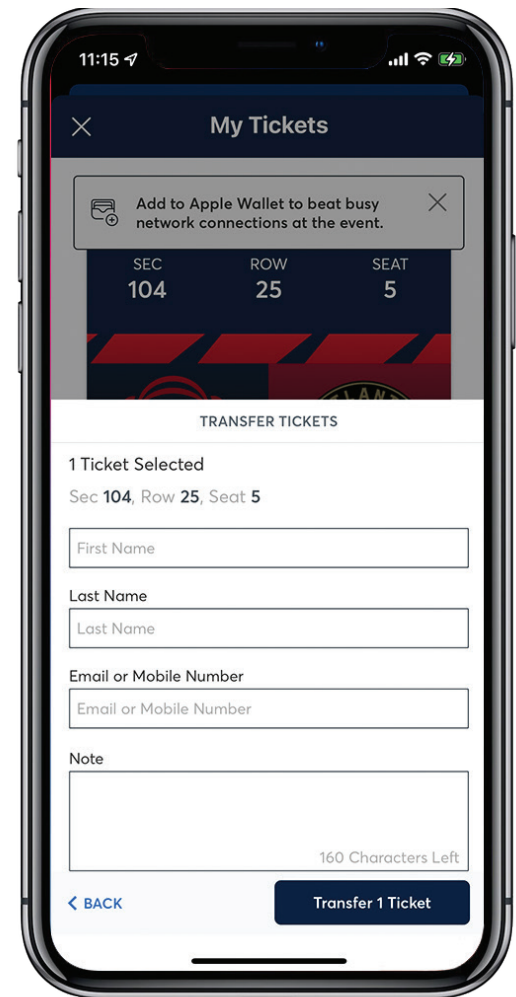

3

Choose from your contacts or manually enter the contact information for the intended recipient. Your recipient must open the generated link and accept the ticket(s).

***As a reminder, screenshots of SafeTix barcode(s) will not be accepted at the gates.
Please be sure to follow the steps outlined to successfully transfer tickets.***

GUEST ASSISTANCE CHAT

TUTORIAL

GUEST ASSISTANCE CHAT

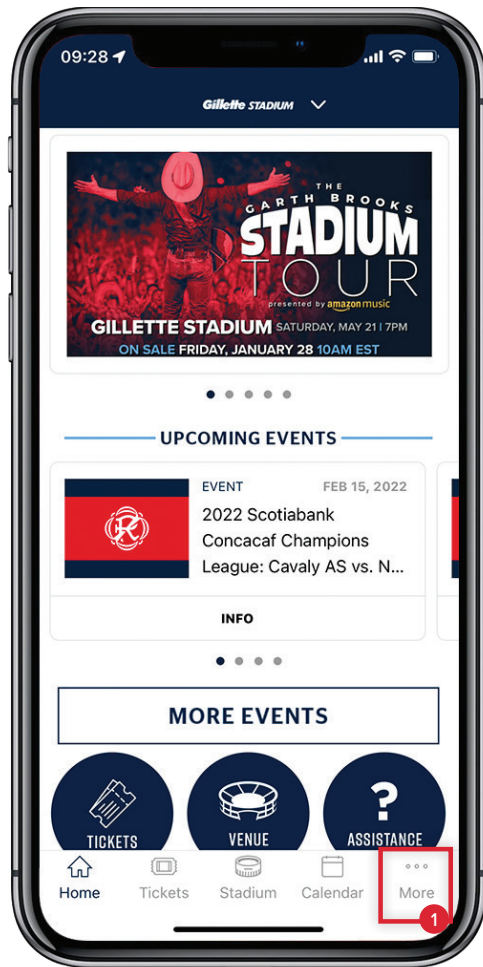

1

From the Gillette Stadium App home screen, click MORE

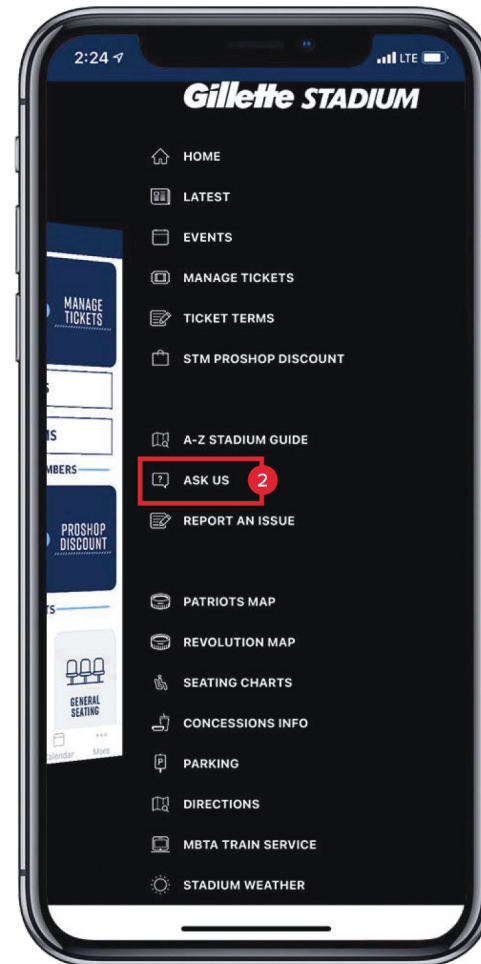

2

Then, select ASK US

GUEST ASSISTANCE CHAT

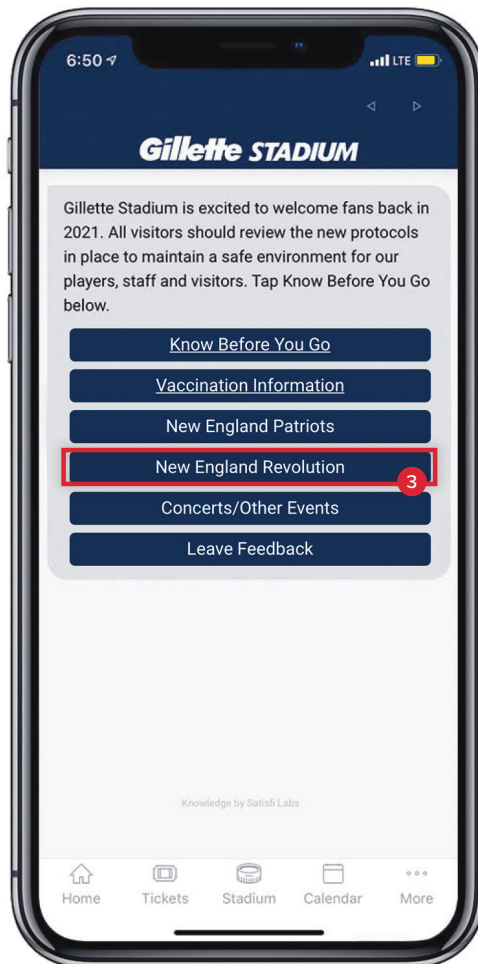

3

If you are at a Revolution game, select NEW ENGLAND REVOLUTION

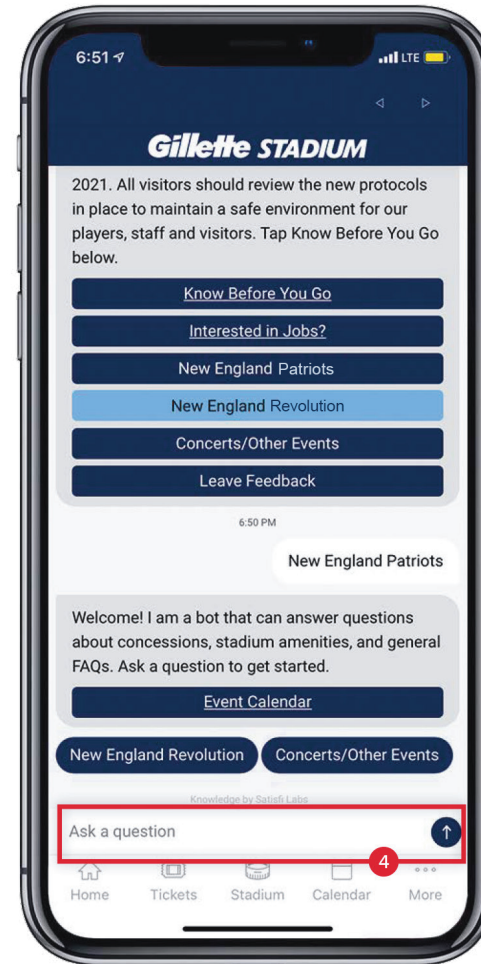

4

Then, ask a question(s) or enter keywords (i.e., Charge Phone, Gluten Free, etc.)

PUSH NOTIFICATIONS

TUTORIAL

PUSH NOTIFICATIONS

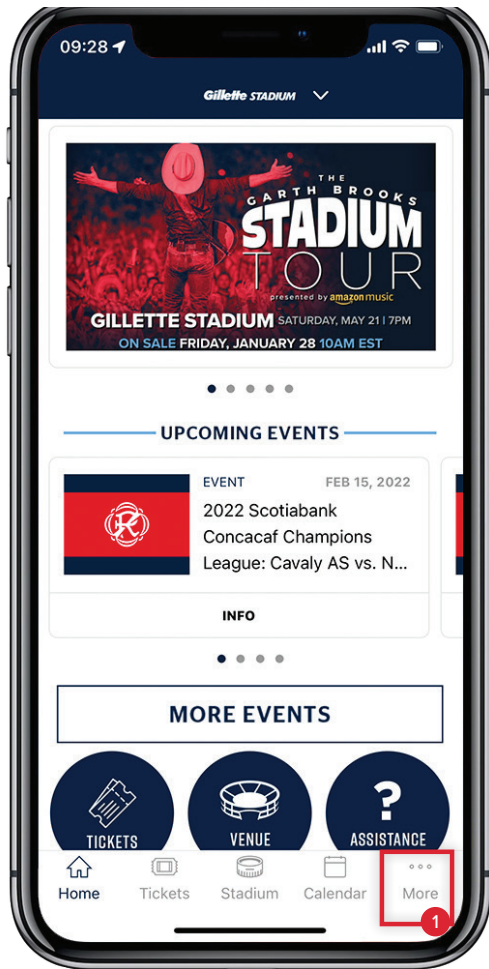

1

From the Gillette Stadium App home screen, click MORE

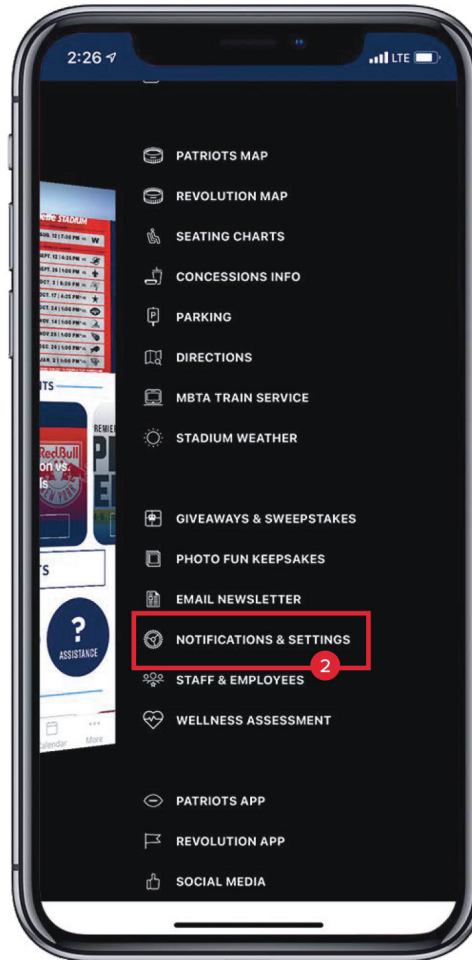

2

Then, select NOTIFICATIONS & SETTINGS

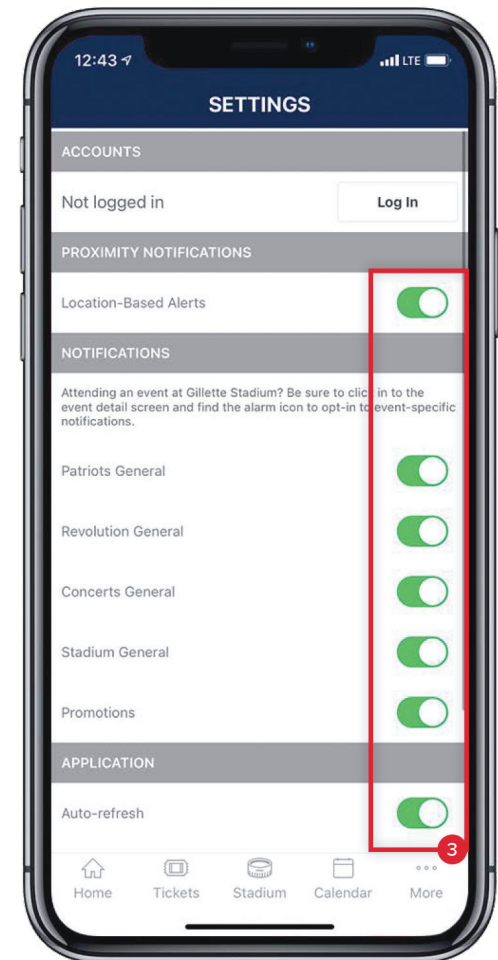

3

Finally, set your notification preferences



THANK YOU

If you have any additional questions, please call **877-GET-REVS**
or email **cs@revolutionsoccer.net**